

COMPACT GRAIN

Many cutting edges combined in one grain



The compact grain (CG) consists of many abrasive grains and reactive filler, which are bonded to each other before adding them to the tool. During grinding, individual worn particles break out of the compact grain, exposing the underlying abrasive particles with new, sharp cutting edges. As a result, tools with compact grain do not clog even with softer or smearing materials.

Due to the double adhesive bonding in the compact grain and abrasive layer, the grinding particles adhere better than with just a single adhesive bonding. This means a longer useful life without premature tool changes. The high density of the cutting edges within the compact grain guarantees the very high stock removal rate, while the filler ensures a cool cut.

P6 CG polishing points

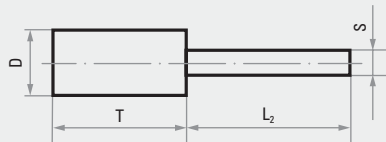
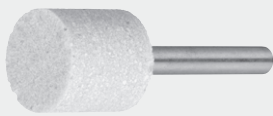

- cylindrical polishing point
- creates perfect surfaces on all metals
- long service life and excellent grain usage
- This polishing point is ideally suited to processing difficult-to-access areas on metal parts.
- the perfect addition to the polishing wheel

★★★

Product number	Description	Quality/grit size	Type/surface result	D mm	T mm	H mm	n_{max} rpm	Pack contains
A29300130203B39	P6ZY 1320.03	EKW 60 SHP CG	extra coarse	13	20	3	117,500	10
A29300130203B59	P6ZY 1320.03	EKW 120 SHP CG	coarse	13	20	3	117,500	10
A29300160206B39	P6ZY 1620.06	EKW 60 SHP CG	extra coarse	16	20	6	95,400	10
A69300160206B59	P6ZY 1620.06	EKW 120 SHP CG	coarse	16	20	6	95,400	10
A69300200206B39	P6ZY 2020.06	EKW 60 SHP CG	extra coarse	20	20	6	76,300	10
A29300200206B59	P6ZY 2020.06	EKW 120 SHP CG	coarse	20	20	6	76,300	10
A29300300306B39	P6ZY 3030.06	EKW 60 SHP CG	extra coarse	30	30	6	50,900	10
A69300300306B59	P6ZY 3030.06	EKW 120 SHP CG	coarse	30	30	6	50,900	10

Recommended for: ● Inox/Steel ● Steel ● Aluminium ● Cast material ● Titanium





Polishing wheel, shape SE1 CG

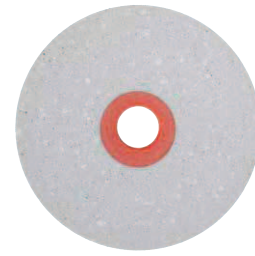
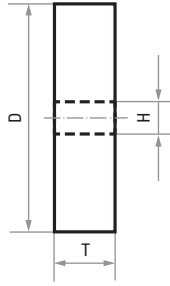

★★★

Product number	Description	Quality/grit size	Type/surface result	D mm	T mm	H mm	n _{max} rpm	Pack contains
A29100800060B39	P6SE1 08006 B.06	EKW 60 SHP CG	extra coarse	80	6	6	19,000	20
A29100800060B59	P6SE1 08006 B.06	EKW 120 SHP CG	coarse	80	6	6	19,000	20
A29101500100B39	P6SE1 15010 B.25	EKW 60 SHP CG	extra coarse	150	10	25	10,100	10
A29101500100B59	P6SE1 15010 B.25	EKW 120 SHP CG	coarse	150	10	25	10,100	10
A29102000200B39	P6SE1 20020 B.25	EKW 60 SHP CG	extra coarse	200	20	25	7,600	10
A29102000200B59	P6SE1 20020 B.25	EKW 120 SHP CG	coarse	200	20	25	7,600	10

Recommended for: ● Inox/Steel ● Steel ● Aluminium ● Cast material ● Titanium

GRINDING AND POLISHING (with bonded tools)



P6PT polishing disc, CG quality

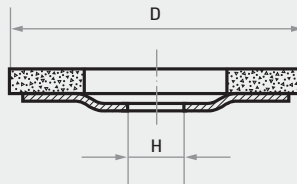

- very hard PU bonding
- can be used on a variety of materials
- contains compact grain (CG)
- suitable for removing irregularities and defects before polishing
- produces good surfaces
- incredible tool life

★★★

Product number	Description	Quality/grit size	Type/surface result	D mm	H mm	n _{max} rpm	Pack contains
A671611506014	P6PT 115 (flat)	EKW 60 SHP CG	extra coarse	115	22.23	13,300	5
A671611512014	P6PT 115 (flat)	EKW 120 SHP CG	coarse	115	22.23	13,300	5
A671612506014	P6PT 125 (flat)	EKW 60 SHP CG	extra coarse	125	22.23	12,200	5
A671612512014	P6PT 125 (flat)	EKW 120 SHP CG	coarse	125	22.23	12,200	5

Recommended for: ● Inox/Steel ● Steel ● Aluminium ● Cast material ● Titanium

The new tools in the P6 Compact Grain series let you remove scratches and irregularities on workpieces, whilst also creating a good surface. This helps you save time and removes the need for annoying tool changes. Their incredible tool life is down to the very hard PU bonding and the compact grain technology. P6 CG tools are perfect for grinding before polishing with other P6 tools with hardness ranging from WP to HP.

Ideal for:

- cleaning surfaces
- removing scratches
- removing paint and undercoats
- repairing surfaces for polishing