

## TECHNICAL INFORMATION AND PRODUCT INFORMATION

**Abrasive rolls and mandrels from LUKAS****SRZY CYLINDRICAL ABRASIVE ROLLS AND SRKE CONICAL ABRASIVE ROLLS**

These abrasive rolls consist of wound abrasive cloth. Their design ensures that new abrasive grain is repeatedly exposed during the grinding process as the outer diameter wears down. Please pay attention to the rotational direction during use and mount the abrasive roll so that the bonded side points towards the mandrel.

**Application examples:**

- Deburring
- Cleaning
- Fettling

**SRTR ABRASIVE ROLL MANDREL**

Reusable tool carrier for secure mounting of the cylindrical and conical abrasive rolls.

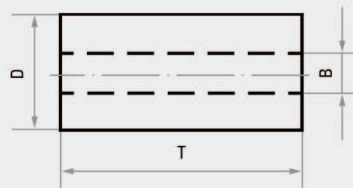
**SRZY Ceramic abrasive roll, cylindrical**

- continuous grinding of small workpieces
- abrasive roll with ceramic grain for an exceptional tool life
- Hardened surfaces, wear-resistant steels, scale and hard coatings, titanium alloys and reinforced weld seams can be machined quickly.
- for deburring, cleaning or fettling of small workpieces
- enormous amount of abrasive coating due to the large, cylindrically wound working surface
- ▶ The matching tool carriers can be found on **page 208**.

★★★

Product number	Description	Grit	D mm	T mm	B mm	$n_{max}$ rpm	Matching abrasive roll mandrels	Pack contains
A2403006380600001	SRZY 0638	Ceramic 60	6	38	3	24,000	SRTR 3063.03 or SRTR 3063.06	50
A2403006380800001	SRZY 0638	Ceramic 80	6	38	3	24,000	SRTR 3063.03 or SRTR 3063.06	50
A2403006381200001	SRZY 0638	Ceramic 120	6	38	3	24,000	SRTR 3063.03 or SRTR 3063.06	50
A2403010380600001	SRZY 1038	Ceramic 60	10	38	3	24,000	SRTR 3070.06	50
A2403010380800001	SRZY 1038	Ceramic 80	10	38	3	24,000	SRTR 3070.06	50
A2403010381200001	SRZY 1038	Ceramic 120	10	38	3	24,000	SRTR 3070.06	50
A2403013380600001	SRZY 1338	Ceramic 60	13	38	3	24,000	SRTR 3070.06	50
A2403013380800001	SRZY 1338	Ceramic 80	13	38	3	24,000	SRTR 3070.06	50
A2403013381200001	SRZY 1338	Ceramic 120	13	38	3	24,000	SRTR 3070.06	50

Recommended for: ● Inox/Steel ● Steel ● Cast material ● Titanium